

SECURITHERM BIOCLIP thermostatic basin mixer

Ref. H9605610L

Single hole, sequential thermostatic mixer H. 95mm L. 120mm





DESCRIPTION

SECURITHERM BIOCLIP thermostatic basin mixer - Ref. H9605610L

Deck-mounted SECURITHERM thermostatic basin mixer.
Sequential thermostatic mixer: opens and closes with cold water.
No risk of cross flow between the hot and cold water.
No non-return valves on the inlets.
BIOCLIP: can be easily removed for cleaning and disinfection.
Anti-scalding failsafe: shuts off automatically if the cold or hot water supply fails.
Securitouch thermal insulation prevents burns.
Single hole mixer with straight spout, H. 95mm L. 120mm, fitted with a hygienic flow straightener, with no build-up of impurities and withstands thermal shocks.
Scale-resistant sequential thermostatic cartridge for single control adjustment of flow rate and temperature.
Adjustable temperature from cold water up to 40°C with maximum temperature limiter set at 40°C.
Thermal and chemical shocks are possible.
Spout and body with smooth interiors and low water volume.
Flow rate limited to 5 lpm at 3 bar.
No manual contact thanks to Hygiene control lever L. 100mm.
Without pop-up waste.
Supplied with copper tails and chrome-plated brass stopcocks.
Fixing reinforced via 2 stainless steel rods.
Mixer ideal for healthcare facilities, retirement and care homes, hospitals and clinics.
Mixer suitable for people with reduced mobility.
30-year warranty.
Also available with PEX flexibles.

TECHNICAL CHARACTERISTICS

SECURITHERM BIOCLIP thermostatic basin mixer - Ref. H9605610L

Connector	M1/2" Ø 15mm
Technology	SECURITHERM BIOCLIP sequential Securitouch
Drop height	95mm
Spout length	120mm
Flow rate	5 lpm at 3 bar
Temperature limiter	Yes
Finish	Chrome-plated brass
Norms	 

ADVANTAGES



Maximum hygiene: no non-return valves



Hygiene: can be removed for internal cleaning



SECURITHERM: anti-scalding safety



Sequential: opens/closes with cold water

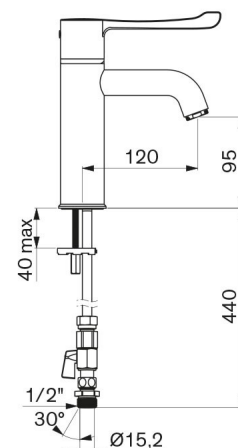

Warranty

