

# SECURITHERM EP BIOSAFE pressure-balancing basin mixer

Ref. 2921TEP

Single hole mechanical mixer H. 100mm L. 110mm

## DESCRIPTION

**SECURITHERM EP BIOSAFE pressure-balancing basin mixer - Ref. 2921TEP**

Deck-mounted mechanical basin mixer with pressure-balancing. Single hole mixer with spout H. 100mm L. 110mm fitted with BIOSAFE hygienic outlet.

Spout suitable for fitting a BIOFIL point-of-use filter. Ø 35mm ceramic cartridge with pressure-balancing and pre-set maximum temperature limiter.

Anti-scalding safety: HW flow rate is reduced if CW supply fails (and vice versa).

Stable temperature regardless of pressure and flow rate in the system. Spout with a tube with a smooth interior, no niches where bacteria can develop, and low water volume.

The speed with which the water flows through the tube considerably reduces biofilm development.

Thermal shocks are possible without removing the lever or shutting off the cold water supply.

Body with very flow water volume (reduces bacterial development).

Flow rate regulated at 5 lpm.

Solid control lever.

No pop-up waste.

F3/8" rotating PEX flexibles with filters and non-return valves.

Fixing reinforced via 2 stainless steel rods.

Mechanical mixer with SECURITHERM pressure-balancing ideal for healthcare facilities, retirement and care homes, hospitals and clinics.

Single hole mixer suitable for people with reduced mobility.

Mixer with 30-year warranty.

## TECHNICAL CHARACTERISTICS

**SECURITHERM EP BIOSAFE pressure-balancing basin mixer - Ref. 2921TEP**

|                     |   |
|---------------------|---|
| Connector           | F3/8"                                   |
| Technology          | SECURITHERM EP BIOSAFE mechanical mixer |
| Drop height         | 100mm                                   |
| Spout length        | 110mm                                   |
| Flow rate           | 5 lpm                                   |
| Temperature limiter | Yes                                     |
| Finish              | Chrome-plated brass                     |



## ADVANTAGES



HW flow rate reduced if CW supply fails



Hygiene: body with very low water volume



Thermal shock without removing the control lever



Pre-set maximum temperature limiter

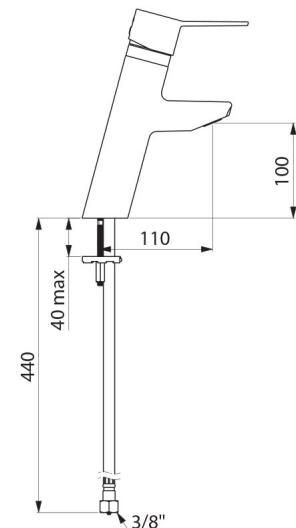

---

Norms



---

Warranty

