

# SECURITHERM thermostatic basin mixer

Ref. H9600

Single hole sequential thermostatic mixer H.95mm  
L.120mm

**2024 UK public price excluding VAT: £386.78**

## DESCRIPTION

**SECURITHERM thermostatic basin mixer - Ref. H9600**

Deck-mounted SECURITHERM thermostatic basin mixer. Thermostatic sequential mixer: opens and closes with cold water.

No risk of cross flow between hot and cold water.

Mixer has no non-return valves on the inlets.

Anti-scalding failsafe: immediate shut-off if cold or hot water supply fails.

Securitouch thermal insulation prevents burns.

Single hole mixer with curved spout H. 95mm L. 120mm fitted with a hygienic flow straightener.

Scale-resistant thermostatic cartridge for single lever control of flow rate and temperature.

Temperature can be adjusted from cold water up to 40°C with temperature limiter set at 40°C.

Thermal or chemical shocks are possible.

Body and spout with smooth interiors and low water volume.

Flow rate limited to 5 lpm at 3 bar.

No manual contact thanks to Hygiene control lever L. 146mm.

No pop-up waste.

Supplied with F3/8" PEX flexibles with chrome-plated brass stopcocks.

Fixing reinforced via 2 stainless steel rods.

Mixer ideal for healthcare facilities, retirement and care homes, hospitals and clinics.

Mixer suitable for people with reduced mobility.

Mixer with 30-year warranty.

Also available with copper tails.

## TECHNICAL CHARACTERISTICS

**SECURITHERM thermostatic basin mixer - Ref. H9600**

Connector	F3/8"
Technology	SECURITHERM Securitouch sequential mixer
Drop height	95mm
Spout length	120mm
Flow rate	5 lpm at 3 bar
Temperature limiter	Yes
Finish	Chrome-plated brass

Norms



## ADVANTAGES



Sequential: opens/closes with cold water



Maximum hygiene: no non-return valves



SECURITHERM: optimal anti-scalding safety



Securitouch: thermal insulation prevents burns

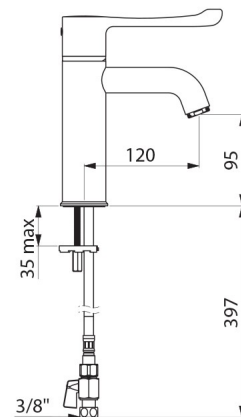

---

Warranty



---

Repairability

