

SECURITHERM thermostatic basin mixer

Ref. H9726

Single hole, dual control tall mixer H. 205 L. 150

2024 UK public price excluding VAT: £489.80





DESCRIPTION

SECURITHERM thermostatic basin mixer - Ref. H9726

SECURITHERM thermostatic dual control basin mixer.
 Tall, single hole mixer with swivelling spout H. 205mm L. 150mm with smooth interior.
 Spout with BIOSAFE hygienic outlet, suitable for fitting a BIOFIL filter.
 Anti-scalding failsafe: shuts off immediately if the cold or hot water supply fails.
 Scale-resistant thermostatic cartridge for temperature control.
 ¼-turn ceramic head for adjusting the flow rate.
 Temperature can be adjusted: cold water up to 41°C.
 Two temperature limiters: first temperature limiter set at to 38°C (can be overridden), and second temperature limiter set at 41°C.
 Thermal shocks are easy to undertake without removing the control knob or shutting off the cold water supply.
 Flow rate regulated at 5 lpm.
 ERGO control knobs.
 Ergonomic pop-up waste, 1 1/4" in brass.
 PEX flexibles F3/8" with filters and non-return valves.
 Fixing reinforced via 2 stainless steel rods.
 Thermostatic mixer ideal for healthcare facilities, retirement and care homes, hospitals and clinics.
 Mixer suitable for people with reduced mobility.
 Mixer with 30-year warranty.





TECHNICAL CHARACTERISTICS

SECURITHERM thermostatic basin mixer - Ref. H9726

Connector	F3/8"
Technology	SECURITHERM thermostatic mixer
Height	307mm
Drop height	205mm
Spout length	150mm
Flow rate	5 lpm
Temperature limiter	Yes
Finish	Chrome-plated brass
Norms	   
Warranty	



ADVANTAGES

- 
SECURITHERM: Optimum anti-scalding safety
- 
Hygiene: smooth interior reduces bacteria
- 
Thermostatic: total temperature stability
- 
Thermal shock possible without removing the lever

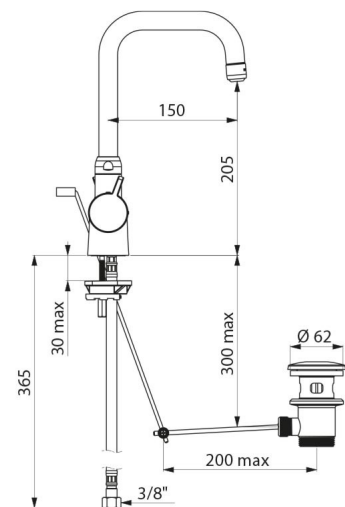

Repairability

