

Be-line® matte white angled grab bar 135°, 220 x 220mm

Ref. 511983W

Matte white aluminium, 3 fixing points

2025 UK public price excluding VAT: £134.00



DESCRIPTION

Be-line® matte white angled grab bar 135°, 220 x 220mm - Ref. 511983W

Be-line® angled grab bar 135°, Ø 35mm, for people with reduced mobility. For use as a handrail (horizontal part) or as a grab rail (135° part), for WCs, showers or baths.

Use as a universal grab bar for either left or right side.

Aluminium tube thickness 3mm. Solid aluminium fixing points.

Rounded profile Ø 35mm with ergonomic flat front face that prevents rotation for an optimal grip.

Matte white powder-coated aluminium; provides a good visual contrast with dark walls.

Uniform surface for easy maintenance and hygiene.

38mm gap between the bar and the wall: minimal space prevents the forearm passing between the bar and the wall, reducing the risk of fracture in case of loss of balance.

3 fixing points prevent the hand from getting trapped and simplify installation.

Concealed fixings.

Supplied with stainless steel screws Ø 8 x 70mm for concrete walls.

Dimensions: 220 x 220mm.

Tested to over 200kg. Maximum recommended user weight: 135kg.

Grab bars for toilets with 30-year warranty. CE marked.

TECHNICAL CHARACTERISTICS

Be-line® matte white angled grab bar 135°, 220 x 220mm - Ref. 511983W

Height	220mm
Length	220mm
Diameter	Ø 35mm
Width to the wall	38mm
Thickness	3mm
Finish	Matte white powder-coated aluminium
Norms	 
Warranty	
Repairability	

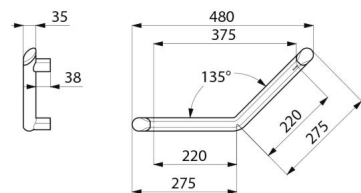

ADVANTAGES



Innovative design suitable for all users



Comfort: ergonomic anti-rotation surface



Tested to over 200kg



38mm gap between bar and wall: space saving