

SECURITHERM thermostatic sequential sink mixer

Ref. H962015

Single hole thermostatic sequential mixer H. 160mm L. 140mm

2025 UK public price excluding VAT: £415.34

DESCRIPTION

SECURITHERM thermostatic sequential sink mixer - Ref. H962015

Deck-mounted SECURITHERM thermostatic sink mixer. Thermostatic sequential mixer: opens and closes with cold water. Single hole mixer with curved spout H. 160mm L. 140mm with hygienic flow straightener for no impurity retention and thermal shock-resistant. Anti-scalding failsafe: automatic shut-off if cold or hot water supply fails. Securitouch thermal insulation prevents burns. No risk of cross flow between hot and cold water. No non-return valves on the inlets. Scale-resistant sequential thermostatic cartridge for single lever control of flow rate and temperature. Temperature can be adjusted from cold water up to 40°C with temperature limiter set at 40°C. Thermal or chemical shocks are possible. Body and spout with smooth interiors and low water volume. Flow rate regulated at 9 lpm. No manual contact thanks to Hygiene control lever L. 146mm. No pop-up waste. Supplied with stainless steel F3/8" PEX flexibles with chrome-plated brass stopcocks, filters and Ø 15mm conical inlets. Reinforced fixing via 2 stainless steel rods. Mixer ideal for healthcare facilities, retirement and care homes, hospitals and clinics. Suitable for people with reduced mobility. 30-year warranty. Also available with copper tails.





TECHNICAL CHARACTERISTICS

SECURITHERM thermostatic sequential sink mixer - Ref. H962015

Supply	1/2", Ø 15mm
Technology	Thermostatic sequential mixer
Drop height	160mm
Spout length	140mm
Flow rate	9 lpm
Temperature limiter	Yes
Finish	Chrome-plated brass
Warranty	



ADVANTAGES

-  Sequential: opens/closes with cold water
-  Maximum hygiene: no non-return valves
-  SECURITHERM: optimal anti-scalding safety
-  Thermostatic: total temperature stability

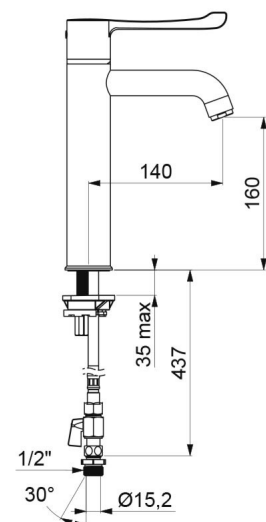

Repairability

